



# SHEFFIELD CITY COUNCIL

## Cabinet Highways Committee

11

---

**Report of:** EXECUTIVE DIRECTOR, PLACE

---

**Date:** 13<sup>th</sup> January 2011

---

**Subject:** Highway Works for the Proposed ASDA development on Chaucer Road.

---

**Author of Report:** Mark Simons, Tel: 0114 2736369

---

**Summary:**

This report is to inform Members of the outcome of public consultation on proposed highway works associated with the ASDA Superstore development on Chaucer Road, to give Council Officer responses to the comments received, and to recommend the way forward.

---

**Reasons for Recommendations:**

This public consultation on the highway works required for the new ASDA Store at Chaucer has helped to develop the highways-related planning conditions attached to planning decision notice 09/03952/FUL (and has added to the statutory consultation undertaken within the planning process). The recommendations to progress the measures are based on the support from a majority of respondents. Additionally, revisions have been made to some of the proposals (where practicable) to address issues and concerns raised by respondents.

In conjunction with some of the proposed measures shown in Appendixes C, D & E, the amended Traffic Regulation Order indicated on the respective drawings will be required to enable safe and efficient operation of the highway.

**Recommendations:**

Approve the series of measures shown on drawing numbers TM-BR242-TRO1A, TM-BR242-TRO2A & TM-BR242-TRO3A (as set out in Appendixes C, D, & E respectively), and construct the scheme.

To make the Traffic Regulation Order, as amended, and set out in drawing numbers TM-BR242-TRO1A, TM-BR242-TRO2A & TM-BR242-TRO3A in accordance with the Road Traffic Regulation Act 1984.

To inform objectors to the advertised Traffic Regulation Order (and lead petitioner from the Medical Centre) accordingly.

---

**Background Papers:** NONE

---

**Category of Report:** OPEN

---

## Statutory and Council Policy Checklist

<b>Financial Implications</b>
YES Cleared by: Liam Gilligan
<b>Legal Implications</b>
YES Cleared by: Julian Ward
<b>Equality of Opportunity Implications</b>
YES Cleared by: Ian Oldershaw
<b>Tackling Health Inequalities Implications</b>
NO
<b>Human rights Implications</b>
NO
<b>Environmental and Sustainability implications</b>
NO
<b>Economic impact</b>
NO
<b>Community safety implications</b>
NO
<b>Human resources implications</b>
NO
<b>Property implications</b>
NO
<b>Area(s) affected</b>
<b>Relevant Cabinet Portfolio Leader</b>
Councillor Ian Auckland
<b>Relevant Scrutiny Committee if decision called in</b>
Culture, Economy and Sustainability
<b>Is the item a matter which is reserved for approval by the City Council?</b>
NO
<b>Press release</b>
NO

## **HIGHWAYS WORKS TO FACILITATE ASDA AT CHAUCER**

### **1.0 SUMMARY**

- 1.1 This report is to inform Members of the outcome of public consultation on proposed highway works associated with the ASDA Superstore development on Chaucer Road, to give Council Officer responses to the comments received, and to recommend the way forward.

### **2.0 WHAT DOES THIS MEAN FOR THE PEOPLE OF SHEFFIELD**

- 2.1 The proposals have been developed to address the requirements of certain conditions applied to the planning consent (09/03952/FUL) for the new ASDA Store at Chaucer which was granted on 23<sup>rd</sup> June 2010. The Developer/Officers have developed measures with a view to satisfying “City of Opportunity” priorities to empower residents by incorporating their aspirations in the design of their streets. This report contributes to “putting the customer first” by responding to the views expressed during the public consultation exercises.
- 2.2 The report will also contribute to the “Protecting and Enhancing the Environment” objective of the Council’s Corporate Plan “A City of Opportunity”, particularly the “Reducing Congestion” priority, with proposals that aim to better manage traffic flows within the Chaucer area of Sheffield. ASDA is a central plank of the overall District Centre strategy of rejuvenation, linked to the provision of other facilities that should reduce the need to travel greater distances by car for local residents.

### **3.0 OUTCOME & SUSTAINABILITY**

- 3.1 The main outcome will be addressing the issues outlined in the Transport Assessment which was produced in respect of the ASDA planning application. This will be achieved by the development and implementation of measures conditioned in the planning consent.
- 3.2 The measures are aimed at accommodating the additional traffic assessed to be generated by the new ASDA Superstore. It is anticipated the various proposals in the vicinity of Chaucer and on the A61 will help to minimise any delays resulting from increased traffic volumes, thereby avoiding compromising the Council congestion targets.
- 3.3 The proposals are aimed at improving road safety and attracting cycling and walking to the store. This will help reduce dependency on the private car, whilst encouraging more healthy physical activity amongst the local community.

### **4.0 REPORT**

- 4.1 Planning consent has been granted for proposals to construct an ASDA Superstore next door to Chaucer Business & Enterprise College. The ASDA development is central to the delivery of the Parson Cross Masterplan and the Southey Owlerton Centres Strategy, both of which were approved by Cabinet in January 2005. The Centres Strategy proposes that Chaucer is redesignated as a District Centre, anchored by a new foodstore. Other investments such as a library learning centre and Public Square are also on site, with future developments and improvements in the pipeline.

- 4.2 The highways-associated conditions attached to the ASDA consent are fairly wide ranging and address travel-related issues (by all modes) both to and from the store, and also to the other development proposals contained within the above-mentioned Masterplan. The measures were highlighted in the information pack that formed the basis of the public consultation (see Appendix A). The key elements of the scheme are:
- Signal-controlled junctions on Halifax Road (A61) at both Chaucer Road and Deerlands Avenue with pedestrian crossing facilities;
  - Alterations to the Chaucer Road/Deerlands Avenue roundabout;
  - Alterations to the Deerlands Avenue/Wordsworth Avenue roundabout, creating a 5<sup>th</sup> arm to serve the proposed customer car park together with improved pedestrian facilities;
  - Signal-controlled pedestrian crossings on Chaucer Road and Wordsworth Avenue;
  - Re-located bus stops on Deerlands Avenue and Wordsworth Avenue, with shelters, raised footways and tactile paving to assist boarding/alighting. Real-time bus arrival/departure information screens will be provided in the entrance area of the foodstore;
  - New access for delivery vehicles to the proposed store. (The specific servicing times and routing of delivery vehicles is controlled by condition and will be via Halifax Road);
  - Provision of a shared pedestrian/cycle route to enable cyclists to negotiate the roundabouts safely;
  - New/revised waiting restrictions (double yellow lines) to accommodate the proposals outlined above.
- 4.3 In order to obtain the views of residents and businesses potentially affected by the proposals, an explanatory letter, plans showing the proposals and a response form were delivered to all premises in the general vicinity of the development. A pre-paid envelope was provided for return of the completed forms. The emergency services and South Yorkshire Passenger Transport Executive were also consulted. A plan showing the boundary of the consultation area (containing some 446 properties) was included in the consultation material (See Appendix A). Details of the proposals were also posted on the Council's web-site.
- 4.4 A Traffic Regulation Order (waiting restrictions) will be required in conjunction with certain elements of the proposals shown on the drawings. The TRO was advertised with notices posted on site which ran concurrently with the public consultation. The response rate from the consultation was 20% (around 90 responses).
- 4.5 Ward Members and the North East Community Assembly Manager (responsible for the area in which Chaucer is located) were all notified about the proposed consultation relating to the highway works. A presentation highlighting the mitigation measures was also given to a TARA meeting on Saturday the 16<sup>th</sup> of October 2010.
- 4.6 Table 1 below gives an indication of the percentage of responses received with regard to each of the questions outlined on the response form.

**Table 1 Public response to the consultation**

		<b>Strongly Agree</b>	<b>Agree</b>	<b>Disagree</b>	<b>Strongly Disagree</b>	<b>Not sure</b>
Q1	"The signal-controlled junctions on Halifax Road at Chaucer Road and Deerlands Avenue junctions, together with the proposed pedestrian crossing facilities will help to regulate traffic movements and improve safety for all road users at these locations".	63%	31%	2%	2%	2%
Q2	"The alterations to the Chaucer Road/Deerlands Avenue roundabout will help to accommodate the increase in traffic and improve pedestrian safety at this location".	55%	30%	7%	2%	6%
Q3	"The alterations to the Deerlands Avenue/Wordsworth Avenue roundabout will provide suitable access to the new store, accommodate the increase in traffic and improve pedestrian safety at this location".	60%	23%	4%	1%	12%
Q4	"The signal-controlled crossings on Chaucer Road and Wordsworth Avenue will make it easier and safer to cross the roads at these locations".	65%	30%	2%	0%	3%
Q5	"The re-sited bus-stops are situated in reasonably accessible locations".	45%	42%	3%	2%	8%
Q6	"The new access for delivery vehicles is unlikely to cause any significant problems for other road-users, including pedestrians".	43%	33%	7%	6%	11%
Q7	"The lengths of shared pedestrian/cycle routes will address safety issues for cyclists negotiating the roundabouts".	49%	31%	3%	4%	13%
		<b>Fully Support</b>	<b>Partly Support</b>	<b>Don't Support</b>	<b>Not Sure</b>	
Q8	Overall, to what extent do you support the scheme?	73%	18%	5%	4%	

4.7 The responses received indicate a substantial majority of respondents agreeing or strongly agreeing with the proposals. However, many of the respondents expressed comments and a number of issues and concerns were raised. These submissions, together with officer responses are set out in Appendix B to this report. No negative feedback to the Consultation was received from the Police, Ambulance Services, or South Yorkshire Fire and Rescue.

4.8 Advertising and posting the Traffic Regulation Order resulted in a petition being received from the Foxhill Medical Centre. The petition was "against the proposed parking restrictions around Foxhill Medical Centre which will cause difficulty for patients accessing the premises". The petition contained 279 signatures. The covering letter attached to the petition stated that the Practice provides care for over 6,000 patients within the community. Many patients are infirmed and thus require convenient and easy access to the premises by motor vehicle. The planned restricted parking around the surgery will cause mayhem and inconvenience. In point of fact, last year a patient fell from his wheelchair because he had to park around the corner

as our disabled parking bay was occupied. A suggestion is made within the letter that perhaps some alternative secure parking could be created nearby (perhaps on land at the end of Wolfe Road or on land by the side of 270 Halifax Road).

- 4.9 A number of other representations were received from residents of Chaucer Road objecting to the proposed waiting restrictions in front of their properties, which would remove the ability to park on-street. No other objections were received to the advertised Traffic Regulation Order.
- 4.10 The Officer response to the petition is that the proposed waiting restrictions on Wilcox Road and the service roads are to ensure the junctions and crossing points are kept clear of parked vehicles in the interests of road safety and the efficient movement of traffic. In view of the level of objection, the length of double yellow lines originally proposed has been reduced to minimise the impact of restrictions. It is considered the restrictions should not be completely omitted, for the reasons stated above. With regard to the difficulties envisaged for disabled patients, the blue-badge scheme entitles such drivers to park on double yellow lines for up to 3 hours, which is likely to be ample time for patients to visit the Medical Centre. Similarly, vehicles will be permitted to stop on the double yellow lines for the purposes of dropping off/picking up passengers. The provision of double yellow lines will ensure the availability of space in the immediate vicinity of the Centre for the above-mentioned purposes. The current lack of restrictions means motorists with no mobility problems can park on-street all day in this location, pushing infirmed patients further afield. Certainly, the junction improvement and pedestrian facilities will better connect the Practice to patients on the east-side of Halifax Road. Officers recommend progression of the amended Order as indicated on the plan included as Appendix E.
- 4.11 The Officer response to the objections from Chaucer Road is to recommend verge hardening as indicated on the plan included as Appendix C. The Traffic Regulation Order (waiting restrictions) will be written in such a way as to allow parking on the verges, which will overcome the objection of on-street parking being lost. The double yellow lines are required to ease the approach of delivery vehicles from the A61.
- 4.12 Financial Implications  
There are no financial implications for the Council as all the highway works associated with this development as outlined in this report are being funded by ASDA. The checking fees of contract drawings and of the actual construction on site (Officer time) is also being funded by ASDA under the terms of the Section 278 Legal Agreement. Highway Authority fees and legal costs are all being absorbed by ASDA.
- 4.13 Equal Opportunity Implications  
All classes of road user will benefit from the proposed measures. An Equalities Impact Assessment has been undertaken and this indicates that the proposals adhere to stated Council policies as they apply to these types of works in the highway. The disabled, elderly and young children (and their carers) have different needs from a project of this type due to issues of accessibility, usability and road safety. However, these differing needs have been taken into account within the design process of the measures outlined in this report. Therefore, the project should be of universal positive benefit to all, regardless of age, gender, ethnicity, sexuality, religion, disability etc. No negative impacts have been identified.
- 4.14 Environmental Implications  
An Air Quality Impact Assessment was undertaken by RSK Stats EHS Ltd as part of the Transport Assessment submitted with the application, as the development will lead to an increase in traffic movement in the local area, which in turn will affect the

local air quality. The assessment predicted a Low Priority Consideration of the air quality owing to the overall levels of nitrogen dioxide concentrations. Whilst being happy with the methodology applied, the Council's Environmental Protection Services (EPS) felt that the levels of nitrogen dioxide concentrations might be slightly higher than those predicted by RSK Stats EHS Ltd. Accordingly, a number of mitigation measures were suggested by EPS, to help offset the increase. Measures being taken forward by ASDA (and conditioned) include; managing dust emissions in line with best practice; three quarters of ASDA's fleet will be Euro IV compliant or better; development of a fleet management agreement; provision of 6 electric charging points (with more promised if the demand is generated); the operation of a store Travel Plan; and measures to promote public transport use such as real-time bus information displays in the Store entrance area.

#### 4.15 Legal Implications

The compliance with Air Quality (England) regulations 2000 (SI928) and the Air Quality (England) (Amended) Regulations (SI3043) raise no legal implications with respect to Air Quality.

### **5.0 ALTERNATIVE OPTIONS CONSIDERED**

5.1 The Transport Assessment undertaken by external Consultants has identified the mitigation measures which subsequently formed the basis of this public consultation. Modelling work was undertaken to ensure that development traffic can be comfortably managed on the local highway network.

5.2 Other alternative options considered included:-

- Replacing the two roundabouts with signal controlled junctions. Operationally, this would have created queuing difficulties. There was also a desire to retain the mature trees and enhance the landscaping within the central islands.
- Consideration was given to having the customer car park entrance in different locations such as off Chaucer Road or Wordsworth Avenue. However, it was felt that taking access directly off the roundabout via a new fifth arm would create the least disruption for residents in terms of vehicle turning movements. A customer access opposite houses would have created a much greater amenity issue.
- As a consequence of feedback generated by the Consultation, the pedestrian crossing on Chaucer Road is being repositioned closer to Chaucer Close. Verge hardening is now proposed along sections of Chaucer Road to accommodate parking. The amount of double yellow lines at the junction of Wilcox Road with Halifax Road has been reduced. Disabled badge holders are allowed to park on double yellow lines so long as they don't compromise road safety. Some new vehicular crossings will also be constructed for properties on Chaucer Road, funded by ASDA.

### **6.0 REASONS FOR RECOMMENDATIONS**

6.1 This public consultation on the highway works required for the new ASDA Store at Chaucer has helped to develop the highways-related planning conditions attached to planning decision notice 09/03952/FUL (and has added to the statutory consultation undertaken within the planning process). The recommendations to progress the measures are based on the support from a majority of respondents. Additionally,

revisions have been made to some of the proposals (where practicable) to address issues and concerns raised by respondents.

- 6.2 In conjunction with some of the proposed measures shown in Appendixes C, D & E, the amended Traffic Regulation Order indicated on the respective drawings will be required to enable safe and efficient operation of the highway.

## **7.0 RECOMMENDATIONS**

- 7.1 Approve the series of measures shown on drawing numbers TM-BR242-TRO1A, TM-BR242-TRO2A & TM-BR242-TRO3A (as set out in Appendixes C, D, & E respectively), and construct the scheme.
- 7.2 To make the Traffic Regulation Order, as amended, and set out in drawing numbers TM-BR242-TRO1A, TM-BR242-TRO2A & TM-BR242-TRO3A in accordance with the Road Traffic Regulation Act 1984.
- 7.3 To inform objectors to the advertised Traffic Regulation Order (and lead petitioner from the Medical Centre) accordingly.

Simon Green  
Executive Director, Place

4 January 2011



## **Appendix A; The Consultation Pack**

- **The consultation letter which explained the scheme**
- **Response form**
- **Relevant drawings (drawing C1 was A3 size)**
- **Details of the area consulted**

**Development Services**

Director: L Sturch, MRTPI

Traffic Section: 2-10 Carbrook Hall Road · Sheffield · S9 2DB

E-mail: [tony.lawery@sheffield.gov.uk](mailto:tony.lawery@sheffield.gov.uk) Fax: (0114) 273 6182

Website: [www.sheffield.gov.uk](http://www.sheffield.gov.uk)

Officer: Mr A Lawery  
Ref: TM/BR242/AL/02

Tel: (0114) 2736170  
Date: 8<sup>th</sup> October 2010

The Occupier

Dear Sir/Madam

**Proposed ASDA Foodstore  
Chaucer Road/Deerlands Avenue  
Associated Highways Works  
Public Consultation**

You may be aware that planning consent for the above development was granted on 23<sup>rd</sup> June 2010. The approval has a number of conditions attached, some of which relate to works in the highway. These works are required to accommodate the anticipated increase in traffic calculated to be generated by the new development and to address potential road safety issues and maintain/improve amenities in the local area.

I now attach for your information copies of the drawings showing indicative details of the works to be undertaken in the highway and which are summarised below:-

- Signal-controlled junctions on Halifax Road (A61) at both Chaucer Road and Deerlands Avenue with pedestrian crossing facilities.
- Alterations to the Chaucer Road/Deerlands Avenue roundabout.
- Alterations to the Deerlands Avenue/Wordsworth Avenue roundabout, creating a 5<sup>th</sup> arm to serve the proposed customer car park together with improved pedestrian facilities.
- Signal-controlled pedestrian crossings on Chaucer Road and Wordsworth Avenue.
- Re-located bus stops on Deerlands Avenue and Wordsworth Avenue.
- New access for delivery vehicles to the proposed Store. (The specified servicing times and routing of delivery vehicles are to be agreed with the Council. It is anticipated the main approaches for delivery vehicles will be via Halifax Road).
- Provision of a shared pedestrian/cycle route to enable cyclists to negotiate the roundabouts safely.
- New/revised waiting restrictions (double yellow lines) to accommodate the proposals outlined above.

Your views are important to us and accordingly, I should be grateful if you would complete the attached response form and return it before 31<sup>st</sup> October 2010 in the envelope provided (no stamp required). Following completion of this consultation, we will consider the responses received and determine if we are able to make minor changes to the proposals to address any concerns brought to our attention.

**P.T.O.**

Additionally, during the consultation period we will advertise a Traffic Regulation Order (TRO) in the Sheffield Star and by means of notices displayed on-street. The TRO is the legal process required to introduce the necessary waiting restrictions shown on the plans. Any representations relating to the TRO must be made in writing during the 3 weeks TRO consultation period (which is currently anticipated to commence on 15<sup>th</sup> October).

When the consultations are completed, a report outlining all the comments and representations received will be prepared for submission to the Cabinet Highways Committee. Members of the public are entitled to attend and, if they so wish, speak at the meeting. Please let me know if this is the case and I will ensure you are notified of the date of the meeting etc, which is likely to be early in the new year.

In the meantime, if you have any queries relating to the proposals, please do not hesitate to contact me on 0114 2736170 or e-mail [tony.lawery@sheffield.gov.uk](mailto:tony.lawery@sheffield.gov.uk).

Yours faithfully

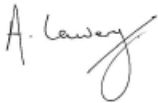
A handwritten signature in black ink, appearing to read 'A. Lawery', with a stylized flourish at the end.

Mr A Lawery  
Principal Engineer, Traffic Management  
Transport & Highways Division

# Proposed Asda Store

## Chaucer Road/Deerlands Avenue

### Associated Highway Works – Public Consultation

Please tell us your views on the scheme detailed on the attached drawings by completing and returning this questionnaire in the prepaid envelope by **31<sup>st</sup> October 2010**.

**How far do you agree or disagree with the following statements.....**

Q1.	“The signal-controlled junctions on Halifax Road at the Chaucer Road and Deerlands Avenue junctions, together with the proposed pedestrian crossing facilities will help to regulate traffic movements and improve safety for all road users at these locations”.	Strongly agree <input type="checkbox"/>	Agree <input type="checkbox"/>	Disagree <input type="checkbox"/>	Strongly disagree <input type="checkbox"/>	Not sure <input type="checkbox"/>
Q2.	“The alterations to the Chaucer Road/Deerlands Avenue roundabout will help to accommodate the increase in traffic and improve pedestrian safety at this location”.	Strongly agree <input type="checkbox"/>	Agree <input type="checkbox"/>	Disagree <input type="checkbox"/>	Strongly disagree <input type="checkbox"/>	Not sure <input type="checkbox"/>
Q3.	“The alterations to the Deerlands Avenue/Wordsworth Avenue roundabout will provide suitable access to the new store, accommodate the increase in traffic and improve pedestrian safety at this location”.	Strongly agree <input type="checkbox"/>	Agree <input type="checkbox"/>	Disagree <input type="checkbox"/>	Strongly disagree <input type="checkbox"/>	Not sure <input type="checkbox"/>
Q4	“The signal-controlled crossings on Chaucer Road and Wordsworth Avenue will make it easier and safer to cross the road at these locations”.	Strongly agree <input type="checkbox"/>	Agree <input type="checkbox"/>	Disagree <input type="checkbox"/>	Strongly disagree <input type="checkbox"/>	Not sure <input type="checkbox"/>
Q5	“The re-sited bus-stops are situated in reasonably accessible locations”.	Strongly agree <input type="checkbox"/>	Agree <input type="checkbox"/>	Disagree <input type="checkbox"/>	Strongly disagree <input type="checkbox"/>	Not sure <input type="checkbox"/>
Q6.	“The new access for delivery vehicles is unlikely to cause any significant problems for other road-users, including pedestrians”.	Strongly agree <input type="checkbox"/>	Agree <input type="checkbox"/>	Disagree <input type="checkbox"/>	Strongly disagree <input type="checkbox"/>	Not sure <input type="checkbox"/>
Q7.	“The lengths of shared pedestrian/cycle routes will address safety issues for cyclists negotiating the roundabouts”.	Strongly agree <input type="checkbox"/>	Agree <input type="checkbox"/>	Disagree <input type="checkbox"/>	Strongly disagree <input type="checkbox"/>	Not sure <input type="checkbox"/>

**Thinking about the proposals overall...**

Q8.	To what extent do you support the scheme?	Fully support <input type="checkbox"/>	Partly support <input type="checkbox"/>	Don't support <input type="checkbox"/>	Not Sure <input type="checkbox"/>
-----	---	---	--	---	--------------------------------------

Q9. Please explain briefly your reasons for supporting or not supporting the proposals

- Please note any representations relating to the new/revised waiting restrictions will be dealt with under the TRO process outlined in the accompanying letter.

**Optional**

Please write your name and address (including post code) below:

**Thank you!**

**Please return your questionnaire in the freepost envelope provided (you do not need a stamp) by 31<sup>st</sup> October 2010.**



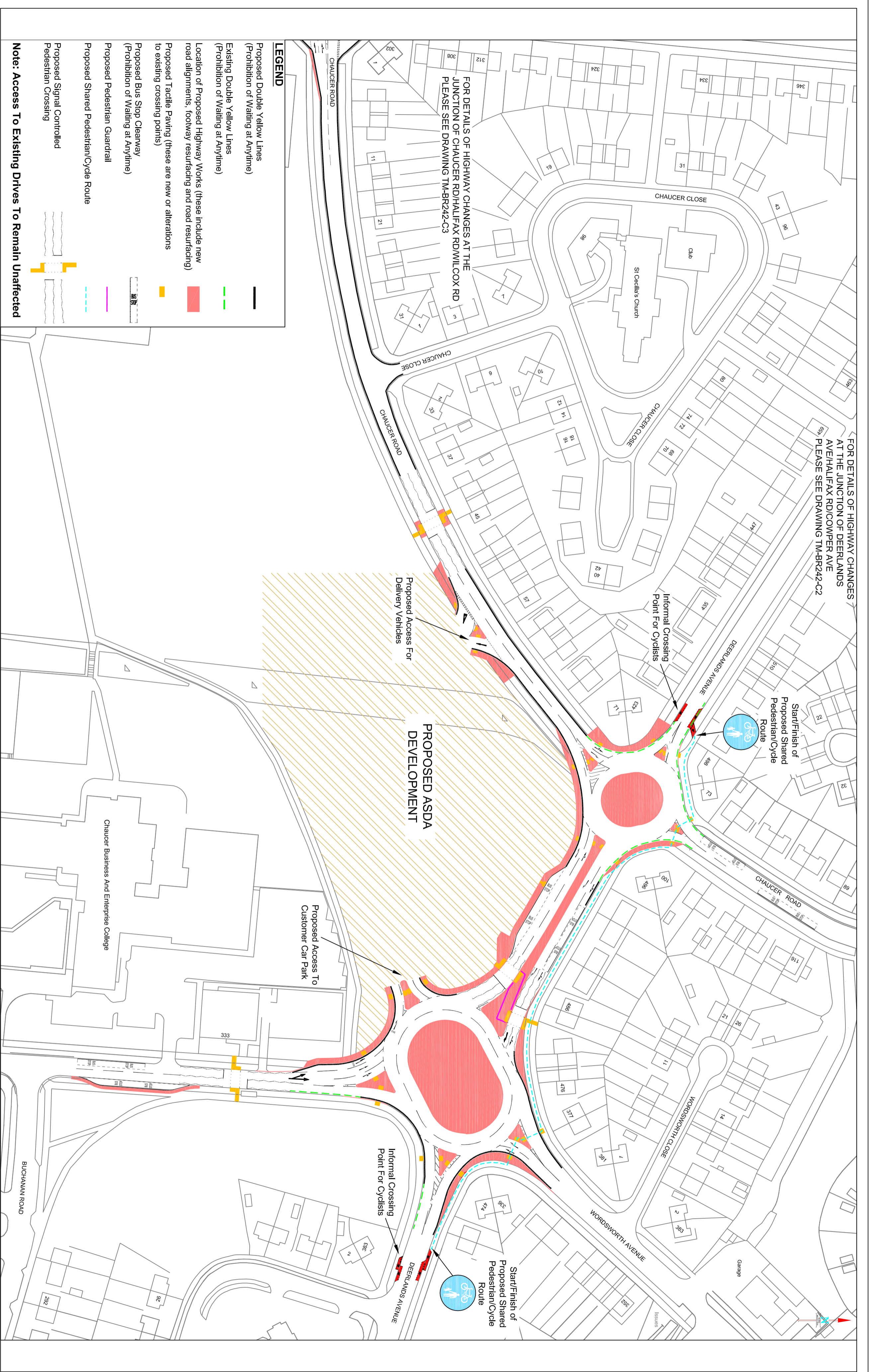

FOR DETAILS OF HIGHWAY CHANGES  
AT THE JUNCTION OF DEERLANDS  
AVE/HALFAX RD/COMPER AVE  
PLEASE SEE DRAWING TM-BR242-C2

FOR DETAILS OF HIGHWAY CHANGES AT THE  
JUNCTION OF CHAUCER RD/HALFAX RD/WILCOX RD  
PLEASE SEE DRAWING TM-BR242-C3

**PROPOSED ASDA  
DEVELOPMENT**

**LEGEND**

- Proposed Double Yellow Lines  
(Prohibition of Waiting at Anytime)
- Existing Double Yellow Lines  
(Prohibition of Waiting at Anytime)
- Location of Proposed Highway Works (these include new road alignments, footway resurfacing and road resurfacing)
- Proposed Tactile Paving (these are new or alterations to existing crossing points)
- Proposed Bus Stop Clearway  
(Prohibition of Waiting at Anytime)
- Proposed Pedestrian Guardrail
- Proposed Shared Pedestrian/Cycle Route
- Proposed Signal Controlled  
Pedestrian Crossing



**DRAWING NO.**  
**TM-BR242-C1**

**DEVELOPMENT SERVICES**  
**TRANSPORT & HIGHWAYS DIVISION**  
**TRAFFIC SECTION**  
2-10 CARRROOK HALL ROAD  
SHEFFIELD S9 2DS  
Tel. 0114-273-6175. Fax. 0114-273-6182  
E-mail Traffic.Management@Sheffield.gov.uk  
Director: L. Surch M.R.T.P.I.  
Development Services

A Service Area of Place  
Sheffield City Council

• Do not scale from this drawing  
• Any errors/omissions to be reported immediately  
• If in doubt, ask

This drawing is based upon Ordnance Survey material with the permission of Ordnance Survey on behalf of the Controller of Her Majesty's Stationary Office. © Crown Copyright. Unauthorised reproduction infringes Crown copyright and may lead to prosecution or civil proceedings. 100018816. 2010

Rev	Date	Content	Signed

**Client**  
**SHEFFIELD CITY COUNCIL**

**Scheme**  
**PROPOSED ASDA STORE**  
**ASSOCIATED HIGHWAY WORKS**

**Drawing Title**  
**PUBLIC CONSULTATION DRAWING**

**DRAWN** M.L. **CHECKED** A.L.

**Drawing No.**  
**TM-BR242-C1**

**Scale**  
**1:1000**

**Date**  
**OCTOBER 2010**

**Sheffield City Council**

**TRAFFIC MANAGEMENT**



**LEGEND**

- Proposed Double Yellow Lines (Prohibition of Waiting at Anytime)
- Proposed Highway Works (these include new road alignments, footway resurfacing and road resurfacing)
- Proposed Tactile Paving (these are new or alterations to existing crossing points)
- Existing Tactile Paving (these are existing crossing points)
- Proposed Pedestrian Guardrail

**Note: Access To Existing Drives To Remain Unaffected**

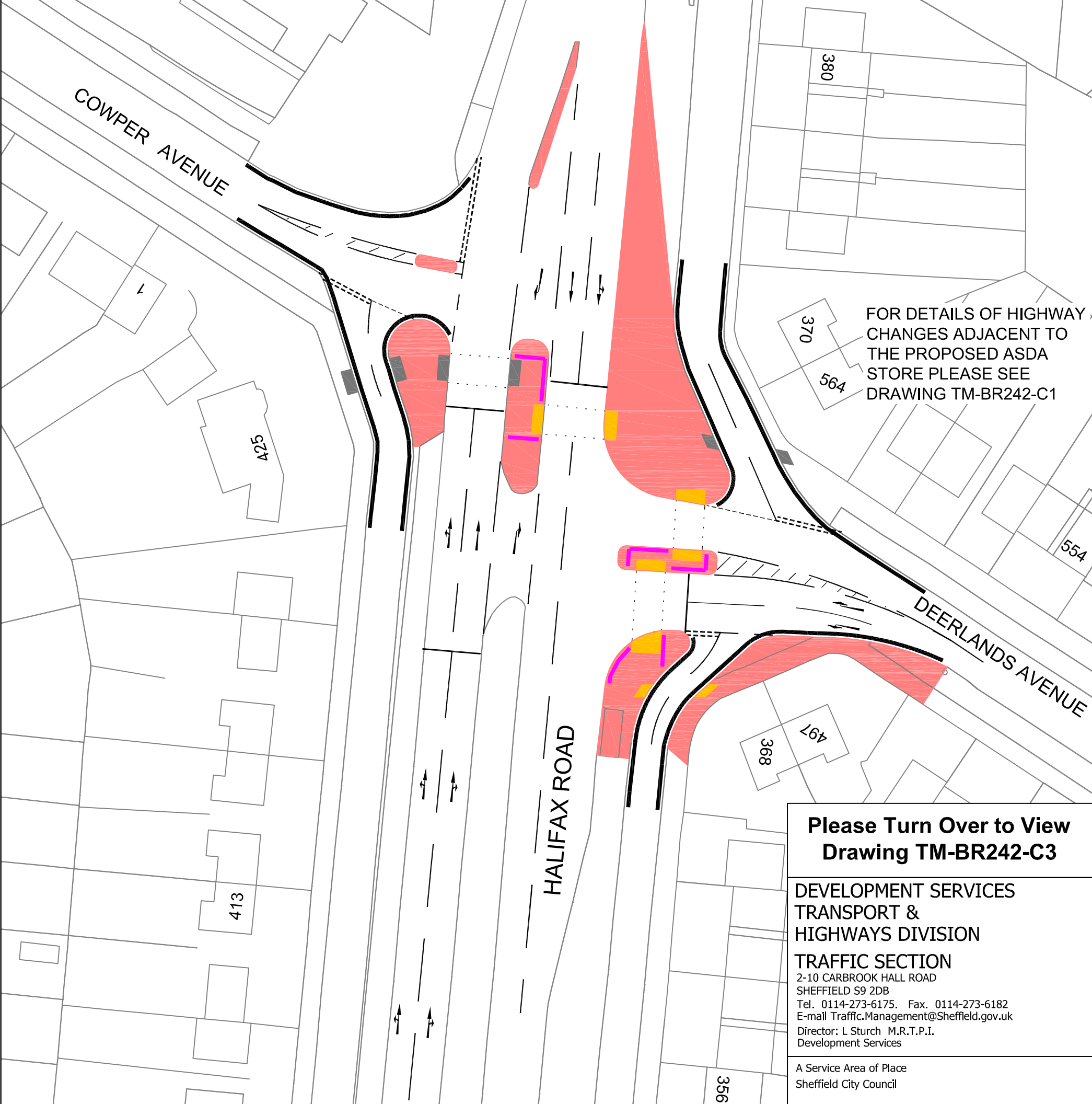

FOR DETAILS OF HIGHWAY CHANGES ADJACENT TO THE PROPOSED ASDA STORE PLEASE SEE DRAWING TM-BR242-C1

**Please Turn Over to View Drawing TM-BR242-C3**

DEVELOPMENT SERVICES  
 TRANSPORT &  
 HIGHWAYS DIVISION  
 TRAFFIC SECTION  
 2-10 CARBROOK HALL ROAD  
 SHEFFIELD S9 2DB  
 Tel. 0114-273-6175. Fax. 0114-273-6182  
 E-mail Traffic.Management@Sheffield.gov.uk  
 Director: L Sturch M.R.T.P.I.  
 Development Services

A Service Area of Place  
 Sheffield City Council

•Do not scale from this drawing  
 •Any errors/omissions to be reported immediately  
 •If in doubt, ask  
 •This drawing is based upon Ordnance Survey material with the permission of Ordnance Survey on behalf of the Controller of Her Majesty's Stationery Office. © Crown Copyright. Unauthorised reproduction infringes Crown copyright and may lead to prosecution or civil proceedings. 100018816. 2010

Client **SHEFFIELD CITY COUNCIL**

Scheme **PROPOSED ASDA STORE ASSOCIATED HIGHWAY WORKS**

Drawing Title **PUBLIC CONSULTATION DRAWING**

Drawing No. **TM-BR242-C2**

Scale **1:500**

**A3**

0 Millimetres 50

Date **OCTOBER 2010**



DRAWN **ML** CHECKED **AL**

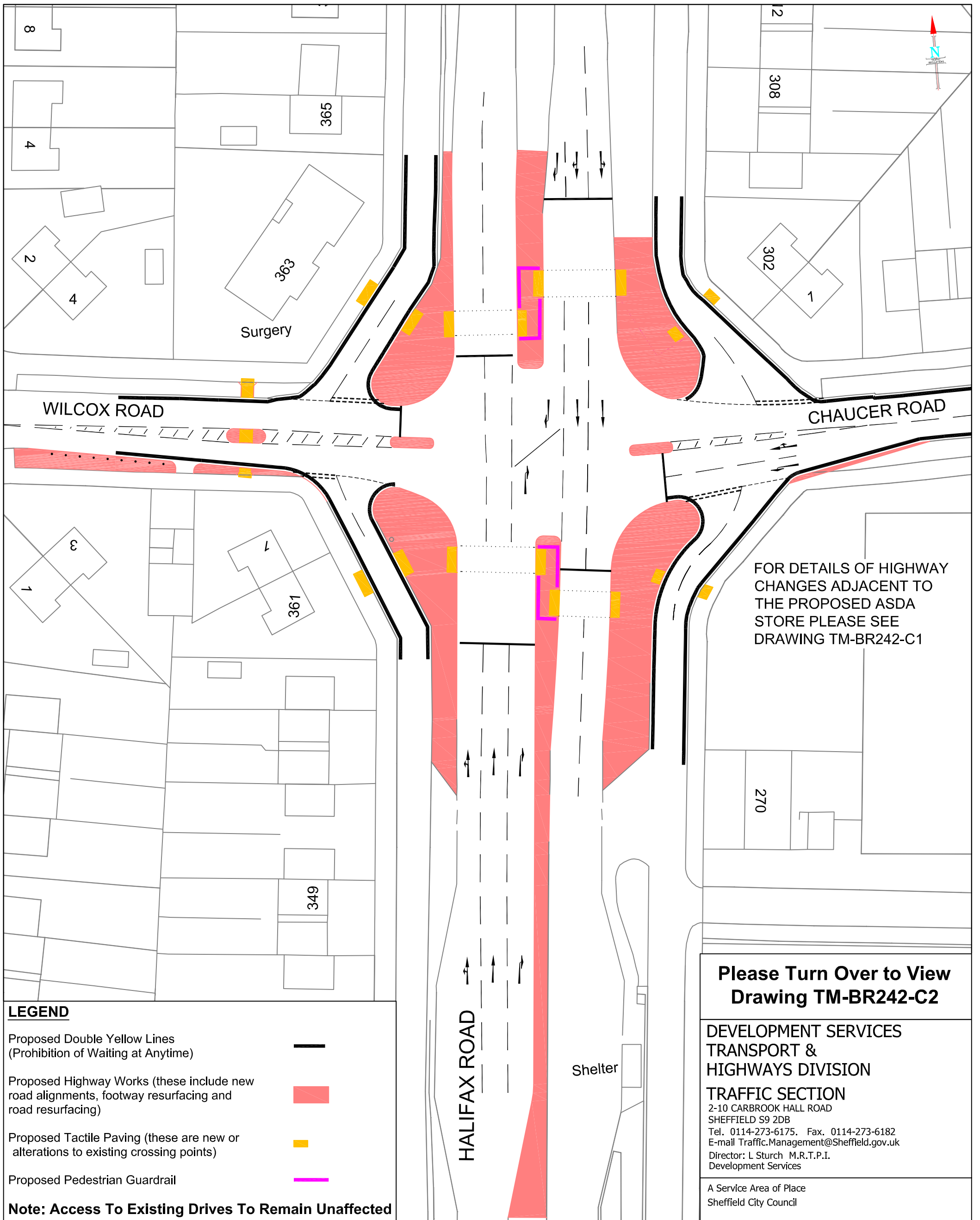

FOR DETAILS OF HIGHWAY CHANGES ADJACENT TO THE PROPOSED ASDA STORE PLEASE SEE DRAWING TM-BR242-C1

**Please Turn Over to View Drawing TM-BR242-C2**

DEVELOPMENT SERVICES  
TRANSPORT &  
HIGHWAYS DIVISION

TRAFFIC SECTION

2-10 CARBROOK HALL ROAD  
SHEFFIELD S9 2DB  
Tel. 0114-273-6175. Fax. 0114-273-6182  
E-mail Traffic.Management@Sheffield.gov.uk  
Director: L Sturch M.R.T.P.I.  
Development Services

A Service Area of Place  
Sheffield City Council

**LEGEND**

Proposed Double Yellow Lines  
(Prohibition of Waiting at Anytime)



Proposed Highway Works (these include new road alignments, footway resurfacing and road resurfacing)



Proposed Tactile Paving (these are new or alterations to existing crossing points)



Proposed Pedestrian Guardrail



**Note: Access To Existing Drives To Remain Unaffected**

•Do not scale from this drawing  
•Any errors/omissions to be reported immediately  
•If in doubt, ask  
•This drawing is based upon Ordnance Survey material with the permission of Ordnance Survey on behalf of the Controller of Her Majesty's Stationery Office. © Crown Copyright. Unauthorised reproduction infringes Crown copyright and may lead to prosecution or civil proceedings. 100018816. 2010

Client  
**SHEFFIELD CITY COUNCIL**

Scheme  
**PROPOSED ASDA STORE  
ASSOCIATED HIGHWAY WORKS**

Drawing Title  
**PUBLIC CONSULTATION DRAWING**

Drawing No.  
**TM-BR242-C3**

Scale  
**1:500**

**A3**



Date  
**OCTOBER 2010**

TRAFFIC  
MANAGEMENT



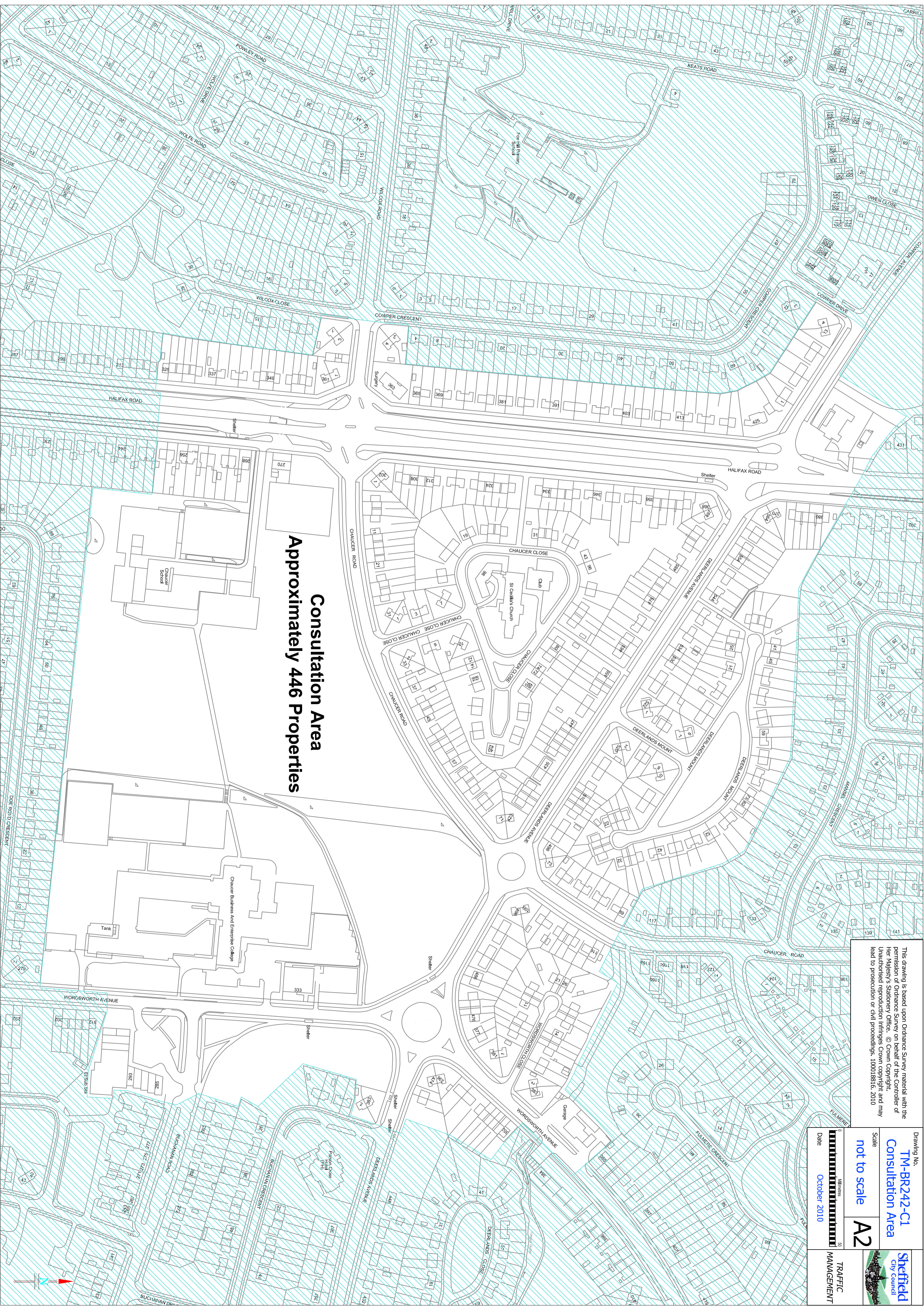

**Consultation Area**  
 Approximately 446 Properties

This drawing is based upon Ordnance Survey material with the permission of Ordnance Survey on behalf of the Controller of Her Majesty's Stationery Office. © Crown Copyright. Unauthorised reproduction infringes Crown copyright and may lead to prosecution or civil proceedings. 100018510. 2010

Drawing No.  
**TM-BR242-C1**  
**Consultation Area**

Scale  
**not to scale**  
**A2**

Millimetres  
 50  
 100  
 150  
 200  
 250  
 300  
 350  
 400  
 450  
 500  
 550  
 600  
 650  
 700  
 750  
 800  
 850  
 900  
 950  
 1000

Date  
**October 2010**

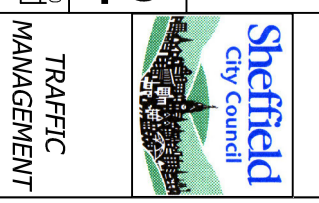



**Appendix B;**

**Comments received during the Consultation & Officer Responses**

## **ASDA DEVELOPMENT, CHAUCER ROAD/DEERLANDS AVENUE**

Comments received together with Officers' responses.

- Concerns expressed about increased traffic volumes having a detrimental effect on road safety, noise, air pollution, congestion affecting residential roads and private accesses. (16 respondents).

Officer response:- It is anticipated that the proposed highway improvements will be largely successful in accommodating the increased traffic volumes, thus reducing the negative impact and mitigating the effects of the additional traffic. Additionally, ASDA have agreed to fund provision of measures to alleviate the effect of the parking restrictions, particularly on Chaucer Road (by means of verge hardening) to provide additional off-street parking and by relocating the proposed controlled pedestrian crossing on Chaucer Road.

- Loss of on-street parking in the vicinity of Foxhill Medical Centre, 363 Halifax Road, particularly detrimental to disabled and elderly patients (5 respondents and 278 signature petition).

Officer response:- The proposed waiting restrictions on Wilcox Road and the service roads are to ensure the junctions and crossing points are kept clear of parked vehicles in the interests of road safety and the efficient movement of traffic. In view of the level of objection, the length of double yellow lines originally proposed has been reduced to minimise the impact of the restrictions. It is considered the restrictions should not be completely omitted, for the reasons stated above. With regard to the difficulties envisaged for disabled patients, the blue-badge scheme entitles such drivers to park on double yellow lines for up to 3 hours, which is likely to be ample time for patients to conclude their business. Similarly, vehicles will be permitted to stop on the double yellow lines for the purposes of dropping off/picking up passengers.

- Concerns relating to migration of parking from Chaucer Road to Chaucer Close (2 respondents)

Officer response:- There are no overwhelming factors which would suggest this would occur. ASDA have agreed to mitigate the effect of the parking restrictions on Chaucer Road by funding works to harden the verges. This provision, together with the existing off-street parking available to most of the properties, is considered adequate to address parking demand at this location.

- Concerns relating to the location of the controlled crossing on Chaucer Road. (3 respondents)

Officer response:- The respondents' concerns centre around the loss of parking and in one instance, the prevention of forming an access to enable provision of off-street parking. In view of these concerns, it is felt the crossing could move to a less sensitive location on Chaucer Road, (near the junction with Chaucer Close), which will minimise the length of zig-zag markings. This would also enable a vehicular access to be formed (if so required by the resident).

- Concerns relating to the location of the delivery access. (4 respondents).

Officer response:- The layout and infrastructure required to serve the new store have been granted planning consent and accordingly, it would not be possible to re-locate the delivery access. ASDA stores are serviced from central distribution depots strategically located throughout the UK. This store will require seven or eight articulated HGV deliveries, evenly spread throughout the course of the day. ASDA have recently successfully implemented tracking technology and on-board computers throughout their distribution fleet. All stores will have the ability to view their planned delivery times throughout the delivery journey. ASDA also utilise the Isotrak system to ensure there are no planned delivery clashes across delivery depots to enable a smooth flow of goods and efficient service yard management at every store. ASDA stores also require deliveries (a similar number to the HGV deliveries) from other suppliers, for example, crisps, bread, milk and papers. The movement of these vehicles are controlled by the store directly with suppliers. The following conditions are attached to the Planning Decision Notice: Condition 48 – No deliveries to the foodstore shall be carried out between the hours of 2300 to 0700 hours Monday to Saturday and 2300 hours to 0900 hours Sundays and Public Holidays. Condition 49 – No servicing to the foodstore shall be carried out between the hours of 2300 to 0700 hours Monday to Saturday and 2300 hours to 0900 hours Sundays and Public Holidays.

- Requests for hardened verges to provide off-street parking and mitigate against the proposed parking restrictions. (3 respondents).

Officer response:- Following further discussion with the developer, ASDA has agreed to fund provision of hardened verges on certain sections of Chaucer Road.

- Concerns relating to the extent of waiting restrictions on the Halifax Road Service roads. (2 respondents).

Officer response:- As with the situation in the vicinity of the Foxhill Medical Centre, the length of double yellow lines will be minimised. It is not, however, considered appropriate to omit the waiting restrictions entirely as these will aid the safe and efficient movement of traffic at the service road junctions.

- Requests for additional controlled pedestrian crossings on Deerlands Avenue (between Halifax Road & Chaucer Road), Chaucer Road (north-east section) and Wordsworth Avenue (north-east section). (2 respondents).

Officer response:- Pedestrian crossing provision on each of these sections is to be provided in the form of dropped kerbs and tactile paving. Controlled crossings at these locations would be difficult to justify in terms of the effect of the development and would give rise to further parking restrictions which would have a negative impact on residents living on those lengths of highway.

- Concerns about loss of parking on Chaucer Road. (5 respondents)

Officer Response:- As outlined above, ASDA have agreed to mitigate the loss of on-street parking by funding a scheme to harden the existing verge along certain lengths of Chaucer Road.

- The increased traffic will result in the Halifax Road service roads being used as rat-runs. (1 respondent).

Officer response:- It is not anticipated this will occur to any significant degree, if at all. The phasing of the traffic signals will be optimised to ensure that queuing on any of the approaches will be kept to a minimum, thus reducing or eliminating the need for motorists to use the service roads.

- Another supermarket in the area is not required. (2 respondents).

Officer response:- This is not pertinent to the associated highways works to which this consultation relates. The development has been granted planning consent and issues of this nature were no doubt fully considered during determination of the application.

- Unable to enjoy off-street parking due to lack of a vehicular crossing (no. 25 Chaucer Road). (1 respondent).

Officer response:- Following further discussions with the developer, ASDA have agreed to fund a vehicular crossing to the property in question. This facility had not been possible previously due to the location of tactile paving at a crossing point. This will become obsolete under the proposed works and will be replaced by a signal controlled crossing in the vicinity of the existing facility.

- Specific support expressed for the ASDA Store. (29 respondents).
- Specific support expressed for the highway works. (16 respondents).

TM/BR242/AL

8<sup>th</sup> November 2010

**DEVELOPMENT SERVICES**  
**TRANSPORT & HIGHWAYS DIVISION**  
**TRAFFIC SECTION**  
 25 SHEFFIELD ROAD  
 SHEFFIELD S1 2DA  
 Tel: 0114 273 6175, Fax: 0114 273 6182  
 Email: traffic.management@sheffield.gov.uk  
 Director: Sueira Misk, P, J, L  
 Development Services  
 A Service Area of Police  
 Sheffield City Council

**DRAWN** **SB** **CHECKED**

• Do not scale from this drawing  
 • Any errors/omissions to be reported immediately  
 • If in doubt, ask  
 • This drawing is based upon Ordnance Survey material with the permission of the Controller of Her Majesty's Stationery Office © Crown Copyright. Unauthorised reproduction infringes Crown copyright and may lead to prosecution or civil proceedings. 100018816, 2010

Rev	Date	Content	Signed

**Client**  
**SHEFFIELD CITY COUNCIL**  
**PROPOSED ASDA STORE**  
**ASSOCIATED HIGHWAY WORKS**

**Drawing Title**  
**TRAFFIC REGULATION DRAWING**

**Drawing No.**  
**TM-BR242-TRO1A**

**Scale**  
**N.T.S.**

**Sheet**  
**A2**

**Date**  
**DECEMBER 2010**

**TRAFFIC MANAGEMENT**

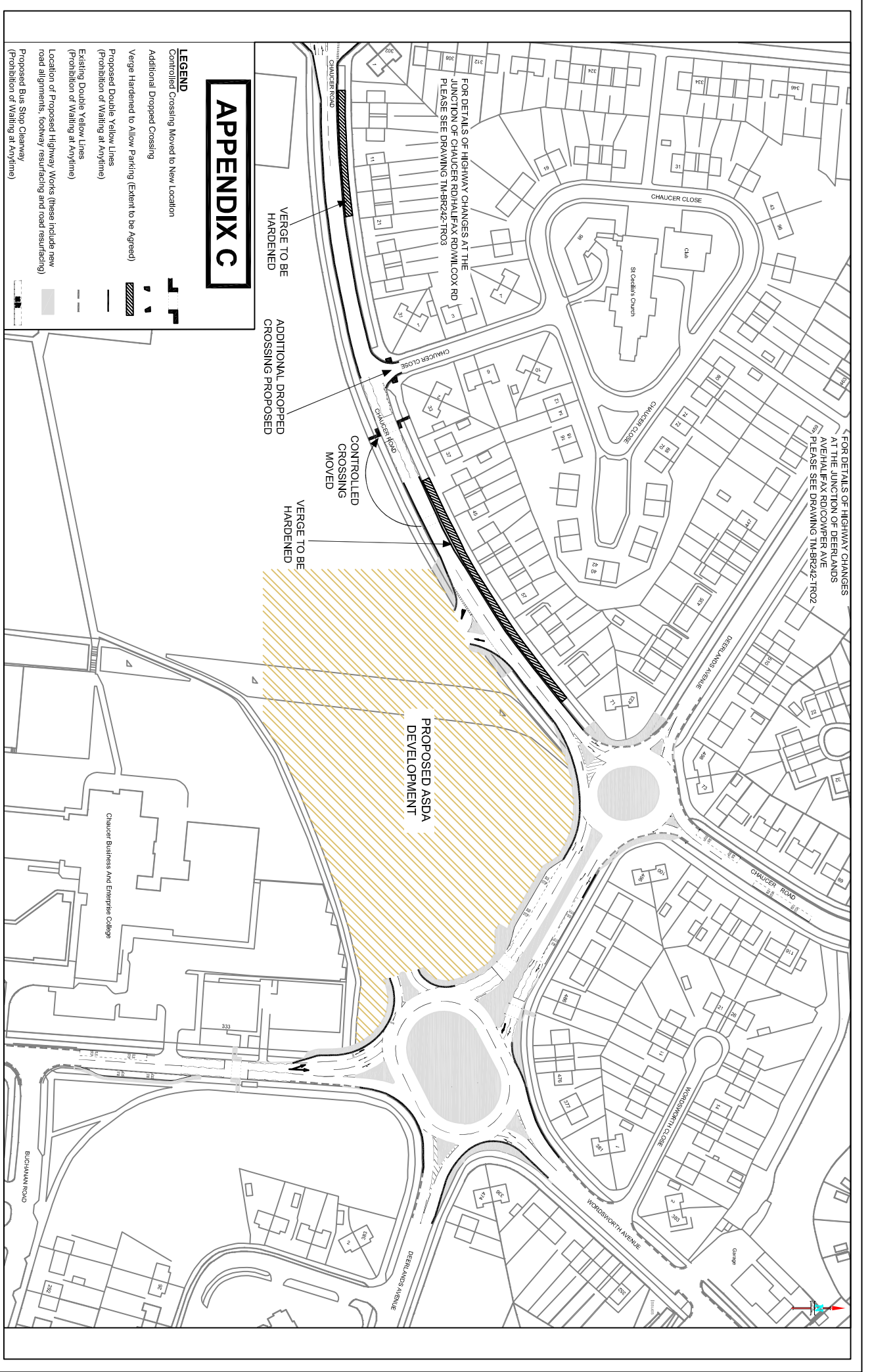

# APPENDIX D

## LEGEND

Proposed Double Yellow Lines  
(Prohibition of Waiting at Anytime)

Proposed Highway Works (these include new road alignments, footway resurfacing and road resurfacing)

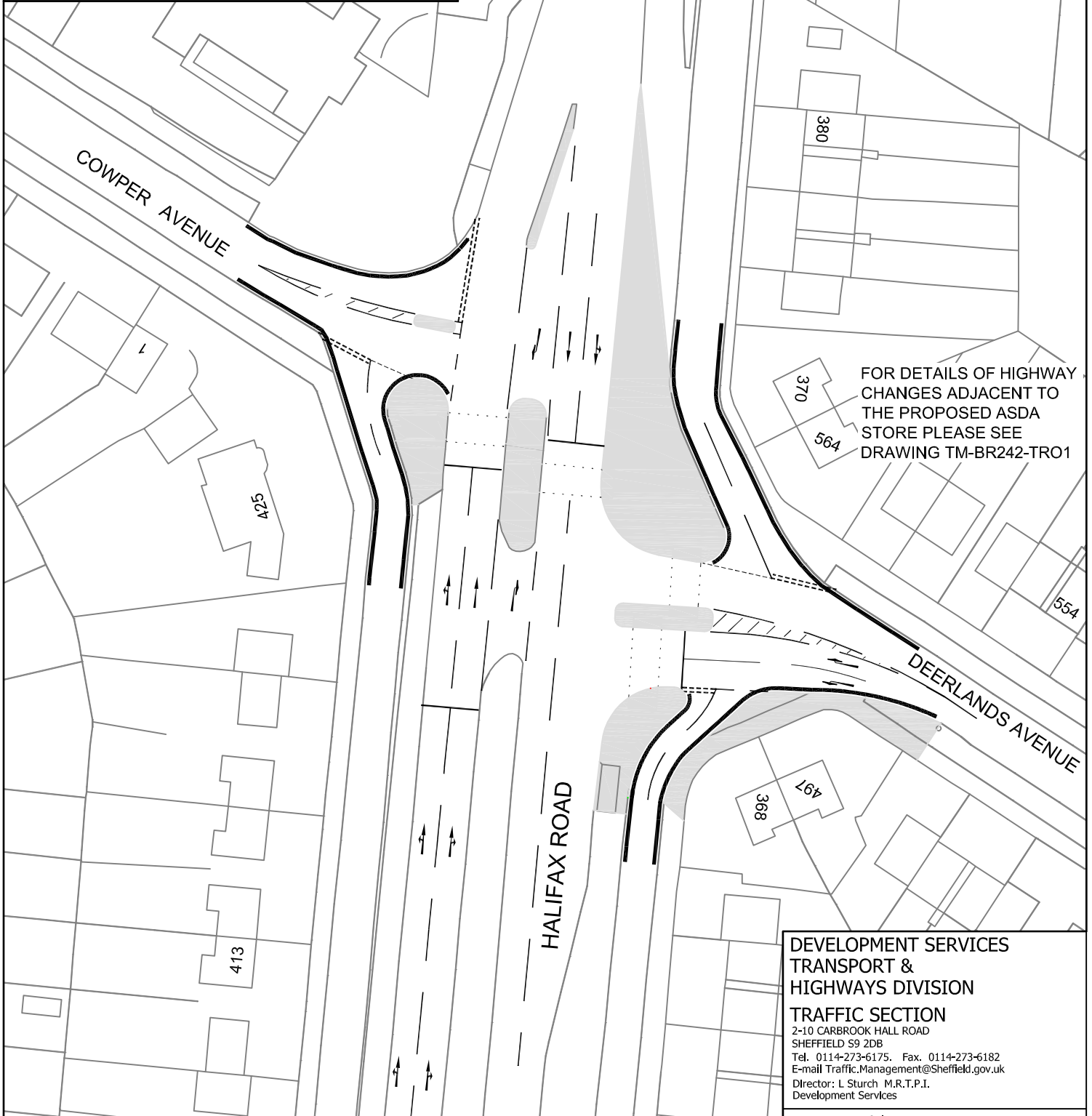

FOR DETAILS OF HIGHWAY CHANGES ADJACENT TO THE PROPOSED ASDA STORE PLEASE SEE DRAWING TM-BR242-TRO1

Please note some existing waiting restrictions have been omitted to aid clarity but will remain as existing unless otherwise stated

**DEVELOPMENT SERVICES  
TRANSPORT &  
HIGHWAYS DIVISION**  
**TRAFFIC SECTION**  
2-10 CARBROOK HALL ROAD  
SHEFFIELD S9 2DB  
Tel. 0114-273-6175. Fax. 0114-273-6182  
E-mail Traffic.Management@Sheffield.gov.uk  
Director: L Sturch M.R.T.P.I.  
Development Services

A Service Area of Place  
Sheffield City Council

- Do not scale from this drawing
- Any errors/omissions to be reported immediately
- If In doubt, ask
- This drawing is based upon Ordnance Survey material with the permission of Ordnance Survey on behalf of the Controller of Her Majesty's Stationery Office. © Crown Copyright. Unauthorised reproduction infringes Crown copyright and may lead to prosecution or civil proceedings. 100018816. 2010

Client **SHEFFIELD CITY COUNCIL**

Scheme **PROPOSED ASDA STORE ASSOCIATED HIGHWAY WORKS**

Drawing Title **TRAFFIC REGULATION DRAWING**

Drawing No. **TM-BR242-TRO2A**

Scale **N.T.S.** **A3**



DRAWN **SB**

CHECKED

Date **DECEMBER 2010**

**TRAFFIC MANAGEMENT**

Please note some existing waiting restrictions have been omitted to aid clarity but will remain as existing unless otherwise stated

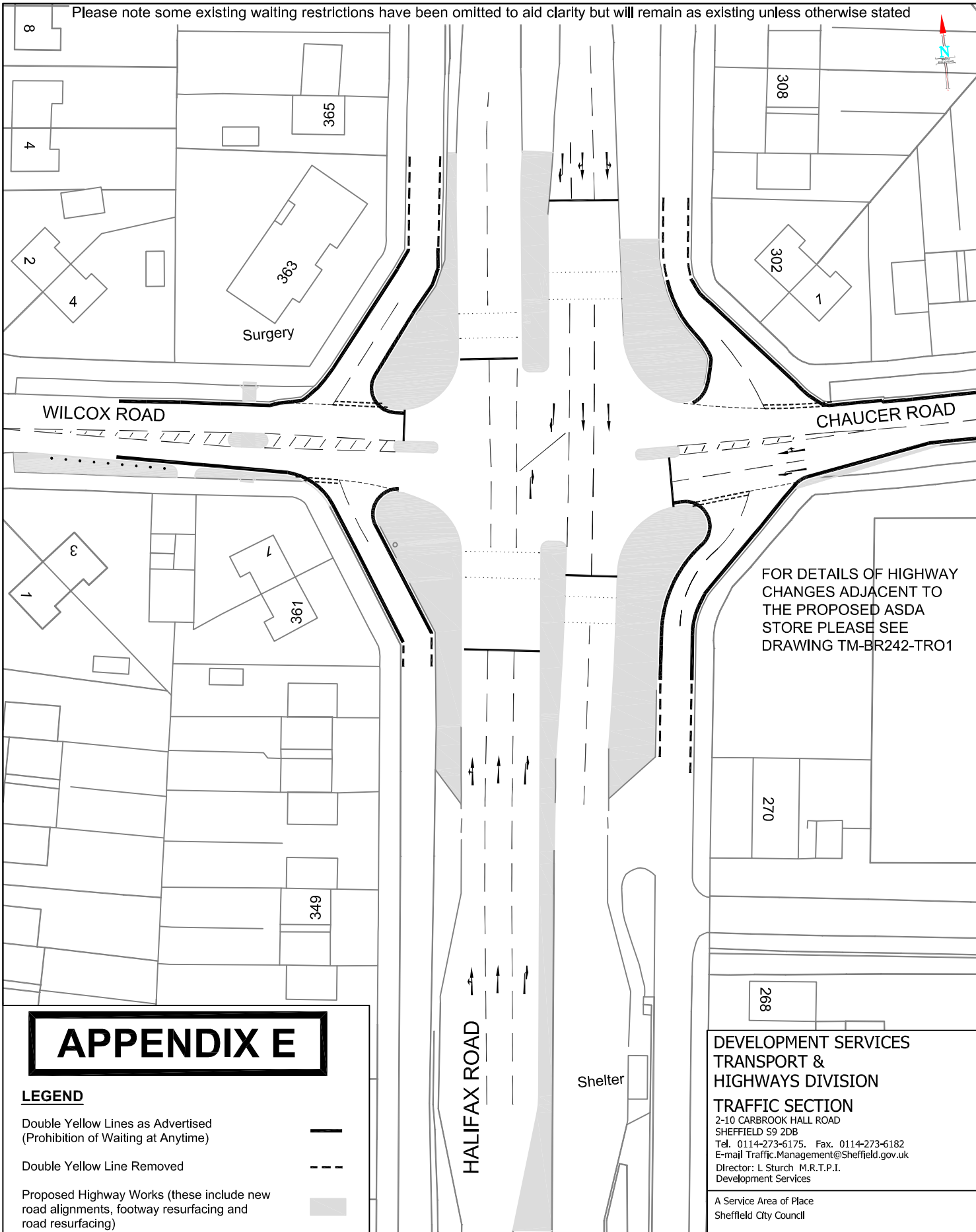

FOR DETAILS OF HIGHWAY CHANGES ADJACENT TO THE PROPOSED ASDA STORE PLEASE SEE DRAWING TM-BR242-TRO1

# APPENDIX E

## LEGEND

Double Yellow Lines as Advertised  
(Prohibition of Waiting at Anytime)

Double Yellow Line Removed

Proposed Highway Works (these include new road alignments, footway resurfacing and road resurfacing)



- Do not scale from this drawing
- Any errors/omissions to be reported immediately
- If in doubt, ask
- This drawing is based upon Ordnance Survey material with the permission of Ordnance Survey on behalf of the Controller of Her Majesty's Stationery Office. © Crown Copyright. Unauthorised reproduction infringes Crown copyright and may lead to prosecution or civil proceedings. 100018816. 2010

Client **SHEFFIELD CITY COUNCIL**

Scheme **PROPOSED ASDA STORE ASSOCIATED HIGHWAY WORKS**

Drawing Title **TRAFFIC REGULATION DRAWING**

DEVELOPMENT SERVICES  
TRANSPORT &  
HIGHWAYS DIVISION  
TRAFFIC SECTION  
2-10 CARBROOK HALL ROAD  
SHEFFIELD S9 2DB  
Tel. 0114-273-6175. Fax. 0114-273-6182  
E-mail Traffic.Management@Sheffield.gov.uk  
Director: L Sturch M.R.T.P.I.  
Development Services

A Service Area of Place  
Sheffield City Council

Drawing No. **TM-BR242-TRO3A**

Scale **N.T.S.** **A3**

Date **DECEMBER 2010**



TRAFFIC MANAGEMENT

DRAWN **SB** CHECKED